

Springfield School District

**SCHOOL SECURITY
AND SAFETY NEEDS**



Information on
School Campus Security and Safety Needs

**SCHOOL SECURITY
AND SAFETY NEEDS**

School Safety Needs that were identified and studied

- *Secure Entrances
- *No Central Main Entrance
- *Improve Accessibility by Adding a Visible Main Entrance
- *Create space for kids to go afterschool who don't go home
- *Parent Pick-up and Drop-Off Zones
- *Parking Lots

The facility task force committee reviewed concepts that would provide a more secure and safe environment that meet today's standards for our children, staff, and the community that utilize our school daily.

The next few slides and pictures will help articulate some of these concerns and why they need to be addressed.

An Example of a Controlled School Entrance

SCHOOL SECURITY AND SAFETY NEEDS

Key issue: Today's safety standards for schools include a Main Entrance housing an administrative office with a controlled entrance that requires you enter through it prior to accessing the building. The schools that are most secure have single access entrances that have double doors coming in. If anybody happens to come in to do harm during the school day, they will basically get trapped between the two entrances. Glass today can repel high level threats.

Another concern is that the high school principal office is buried on the second floor and not accessible to the public. About 8 out of 10 visitors that come through the district office need to access high school office & staff.

Example



Controlled entrance example

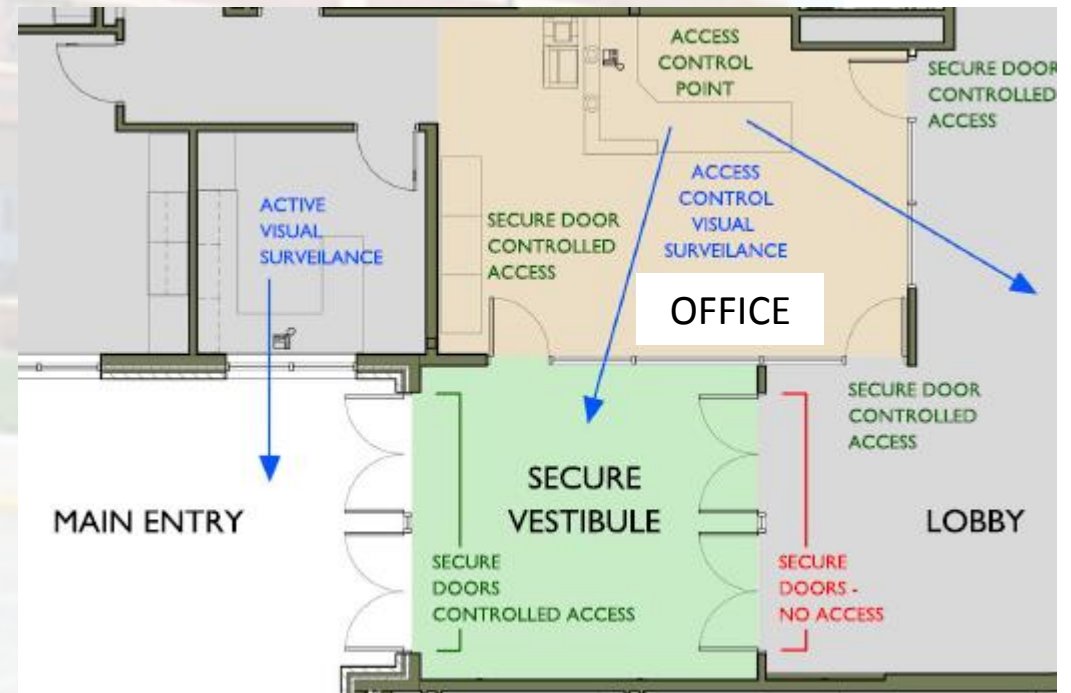

Our current entrance E1 serves as the main school day entrance for the Preschool, High School and District Office. It needs a controlled entrance

SCHOOL SECURITY AND SAFETY NEEDS

Lack of Controlled Entrances/Vestibules.

A concern is that our existing entrances are not controlled.

We buzz people in, but visitors are not forced to enter through an controlled entrance.



This is the main school-day entrance E1 for the high school and district office. It was built in 1951. It is located by the preschool, early childhood classrooms, and district office.

The district installed a “buzz-in” system in 2013 to help control building access. A concern exists where visitors after being “buzzed-in” are not regulated to enter into an administrative office.

8 out of 10 visitors that enter here need to go to the High School Office located on the 2nd floor. Many elementary visitors come through here too, but need to be redirected to the other corner of the building.

A common complaint is that people never know which door they should use to enter our school.



This is the same entrance E1 by the preschool. After visitors are “buzzed” in, they can access the upstairs as the construction design in 1951 when this part of the school was built did not have the safety features sought after in today’s school buildings.

Our current entrance S1 serves as the other main school day entrance for the Elementary Office. It also needs a controlled entrance.

SCHOOL SECURITY AND SAFETY NEEDS

Lack of Controlled Entrances/Vestibules.

A concern is that our existing entrances are not controlled.

We buzz people in, but visitors are not forced to enter through a controlled entrance.



This is the entrance S1 by the elementary principal office. After visitors are “buzzed” in, they can access the elementary without. This construction design is from 1994 and is one of the most recent section of our school. At that time, school’s were not built with the safety features sought after in today’s school buildings.

Parent Pick-Up and Drop Off Zones

SCHOOL SECURITY AND SAFETY NEEDS

A concern is that the parent drop zone off of “Burns Avenue” is problematic. Snow can't be cleared along the grass boulevard. Kids are dropped off and climb over the snow while exiting their vehicles. At times the snow bank can get slippery causing more concerns with kids slipping under a vehicle.



Main Elementary Parent
Pick-up and Drop-Off Zone
on Burns Ave.

Parent Pick-Up and Drop Off Zones

SCHOOL SECURITY AND SAFETY NEEDS

Along the south side of the elementary on “Wilson Street”, snow can’t be cleared along the grass boulevard. Here is an example of how families in this drop off/pick up zone climb over the snow to go to and from the school.



Parent Pick-up and
Drop-Off Zone along
Wilson Street.

An example of a Visible Main School Entrance

SCHOOL SECURITY AND SAFETY NEEDS

Secure Entrances and a Main entrance that could serve our day/night school and community usage would greatly improve security and safety for our campus. Visibility and prominence brings clarity to where visitors are to enter and “check-in” and for after school events as seen in examples below.

Example of a Visible/Intuitive Main Entrance



Example of a Visible/Intuitive Main Entrance

The schools that are most secure have single access entrances that have double doors coming in. If anybody happens to come in to do harm during the school day, they will basically get trapped between the two entrances. Glass today can repel threats.



Google It- Here is our school campus

SCHOOL SECURITY AND SAFETY NEEDS

A more recent view would include the addition of the East Parking Lot by the Greenhouse.

There are advantages of having the school facility in the heart of a community. One issue is being landlocked and lack of available greenspace for students.



Parking Lot Locations. Expanding East Lot has been beneficial.

SCHOOL SECURITY AND SAFETY NEEDS

Here is designation of the parking lots around the school.

Expanding the east parking lot greatly improved the safety around the building.

Moving the students vehicles off the residential areas have made safer conditions for pedestrians and students biking to school.

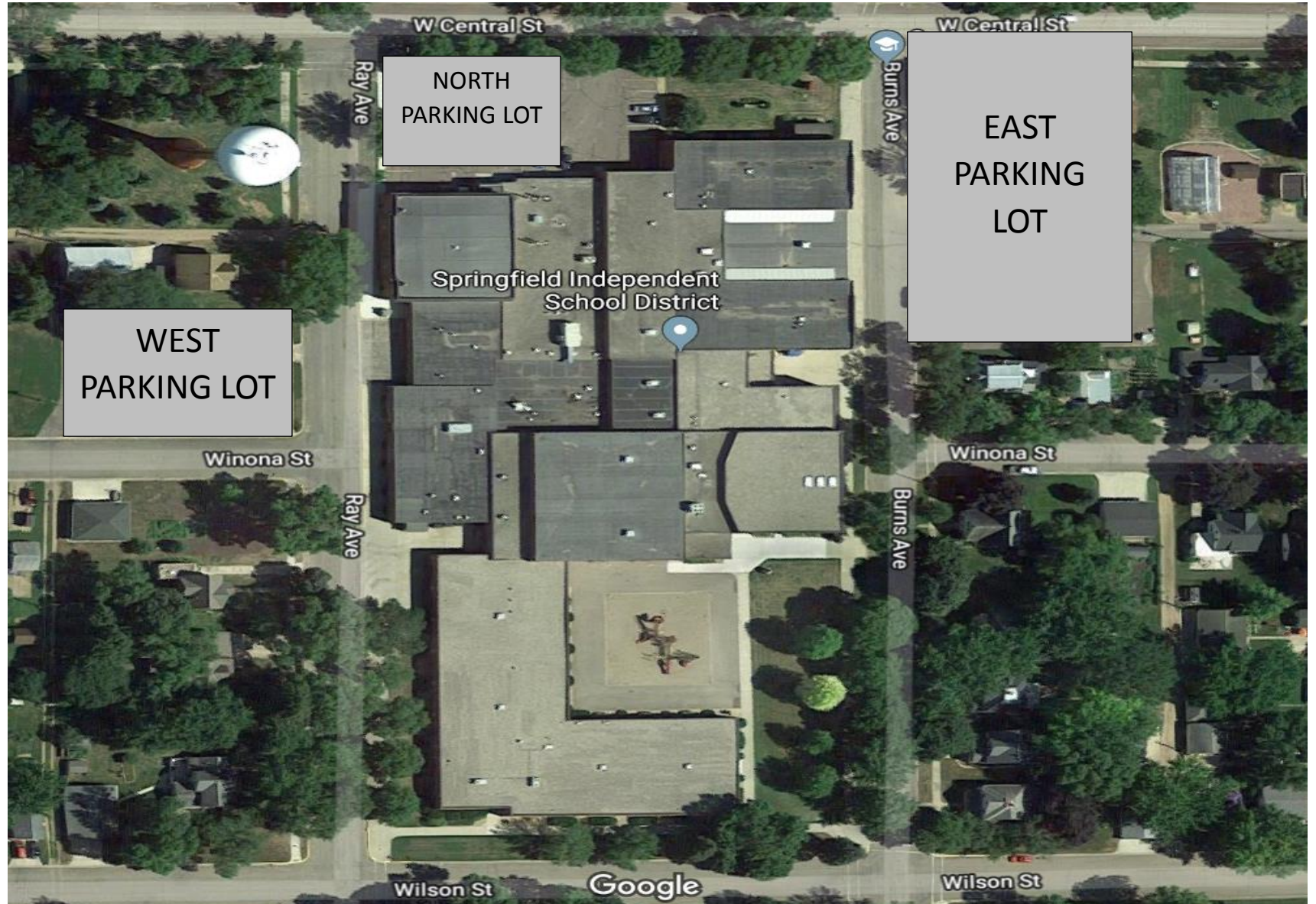

Day Entrances

SCHOOL SECURITY AND SAFETY NEEDS

Here are the designated entrances we want people to use during the school day.

There are issues with how they are designed as they don't meet the safety features sought after in today's school buildings.

Another issue is they are not intuitive. People consistently identify that they are not sure where to enter our school.

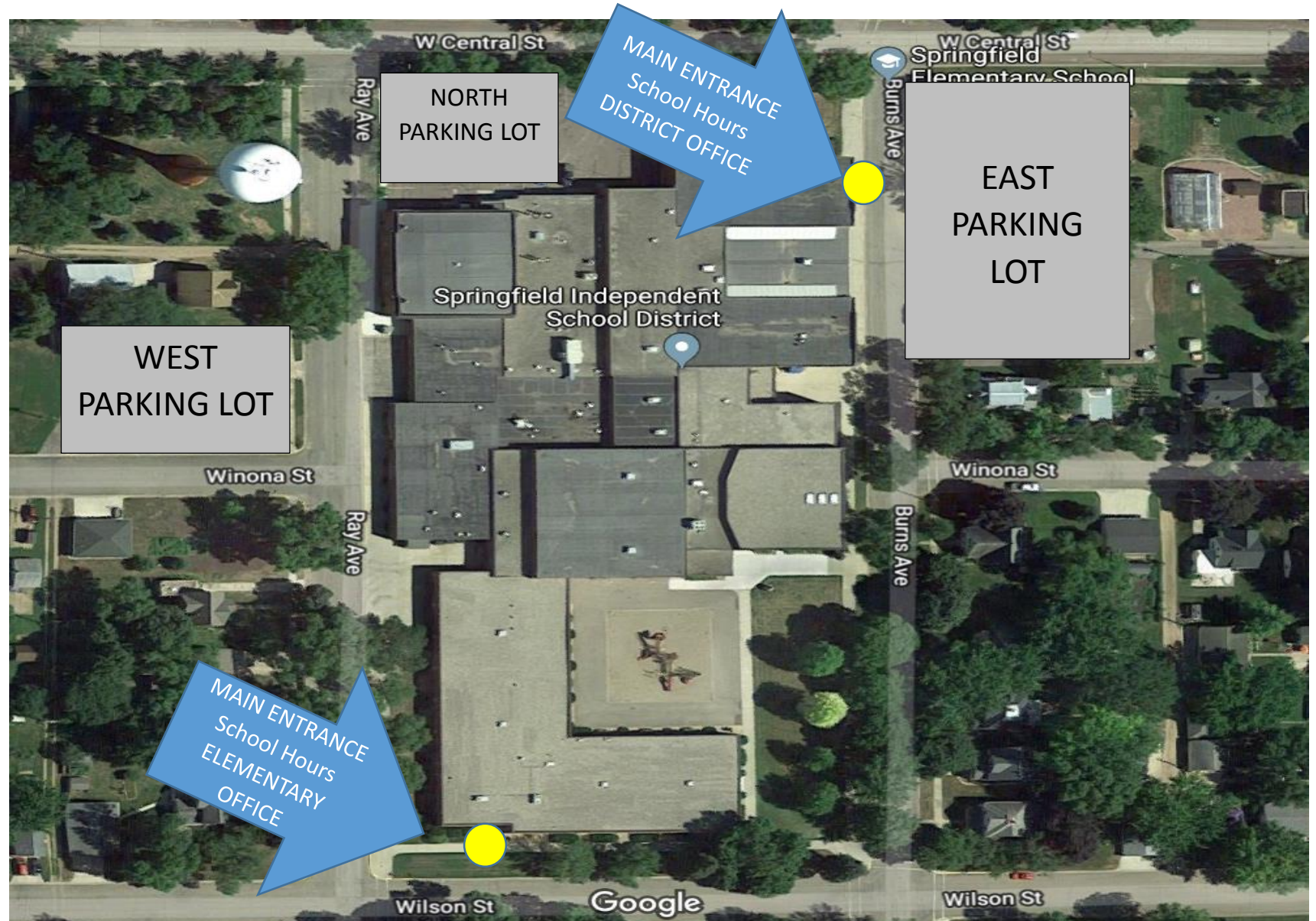

SCHOOL SECURITY AND SAFETY NEEDS

W Central St

Springfield Elementary School

Ray Ave

NORTH PARKING LOT

MAIN ENTRANCE
School Hours
DISTRICT OFFICE

Current H.S. Admin 2nd floor

EAST PARKING LOT

Winona St

Ray Ave

WEST PARKING LOT

Wilson St

Google

Wilson St

Possible relocation of HS Admin Offices and main entrance

A better location for their offices to serve community and provide for a more visible entrance to serve district afterschool use might be here. Easily seen from East parking lot

A better location for their offices to serve the community and provide for a more visible entrance to serve day & afterschool use might be here. Easily seen from East parking lot

Currently our After School Entrances are not Intuitive and Different from Day Entrances.

SCHOOL SECURITY AND SAFETY NEEDS

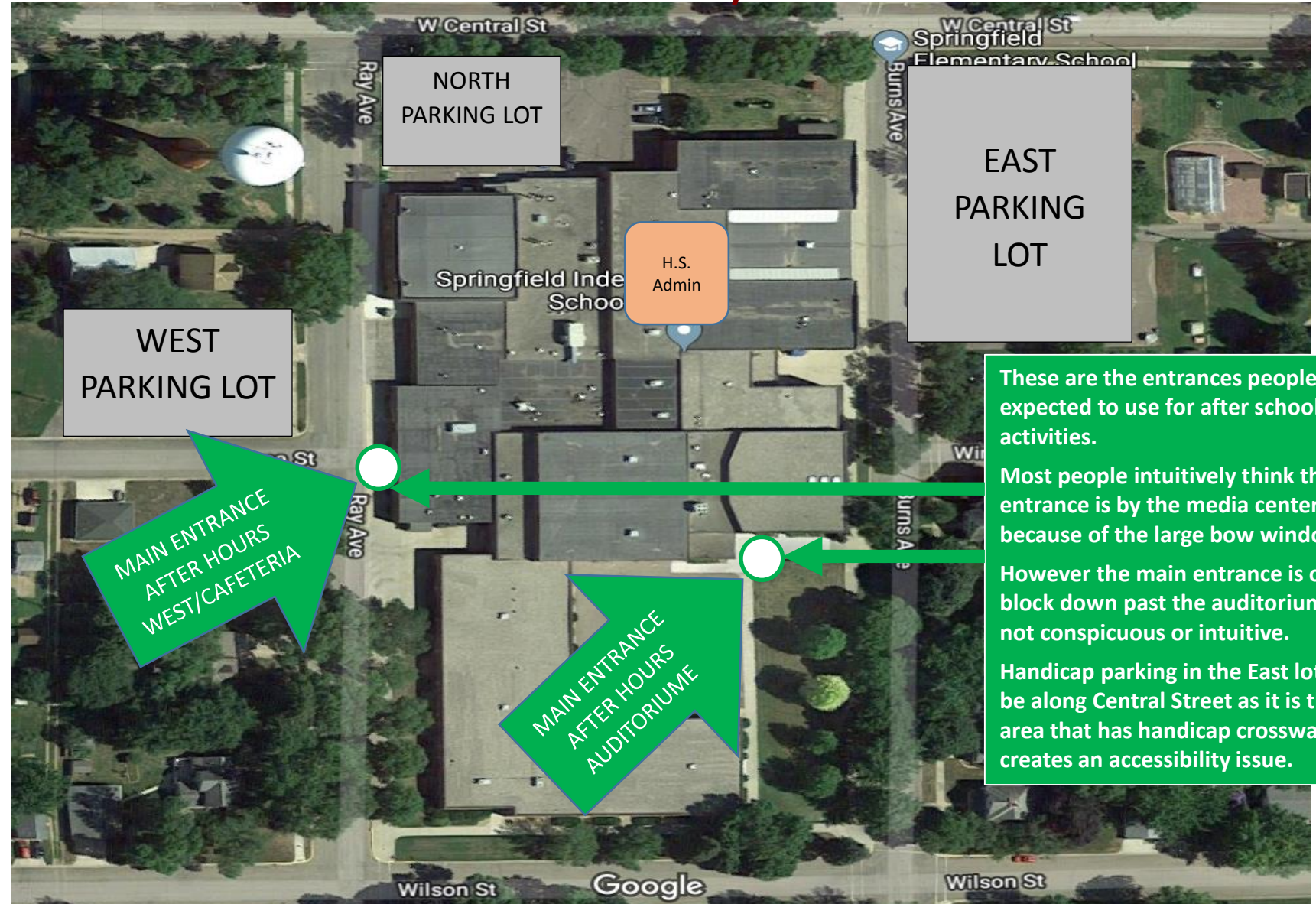

These are the entrances people are expected to use for after school activities.

Most people intuitively think the main entrance is by the media center because of the large bow window.

However the main entrance is one block down past the auditorium. It is not conspicuous or intuitive.

Handicap parking in the East lot has to be along Central Street as it is the only area that has handicap crosswalk. This creates an accessibility issue.

School Building Lacks an intuitive main entrance that can better regulate access

SCHOOL SECURITY AND SAFETY NEEDS

The district monitors two entrances for afterschool activities and two different entrances for daytime school use. It would be most functional and provide a “safer school environment” if one main entrance existed that could be utilized for both day and night.

Below is the East side of the school which coexists with our main East parking lot. The District Office Entrance is for day use and the auditorium entrance is one of the two entrances for night use.

Opportunities exist to create a main entrance that would provide necessary safety measures, be very functional, and intuitively clear that this is where school visitors should enter.

Visitors to our school, especially after school hours, really don’t have a clear understanding where to go.

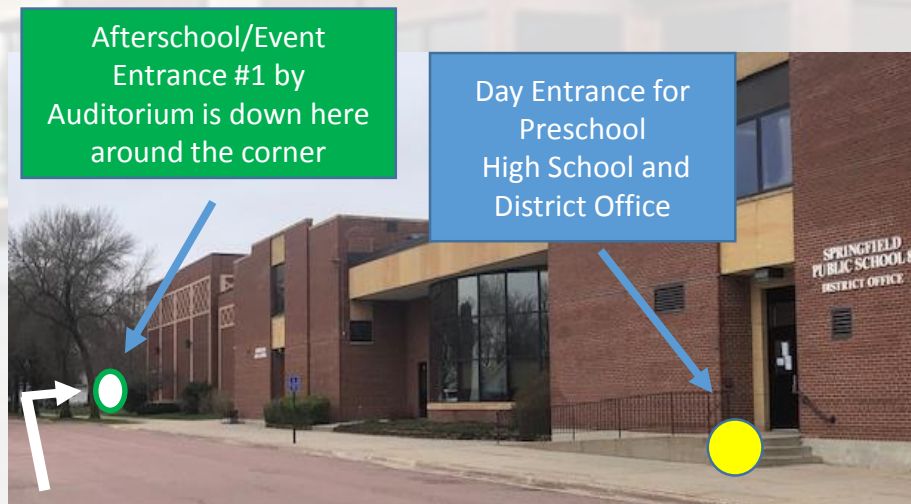

View from East Parking Lot
Afterschool entrance(O) is not visible or intuitive

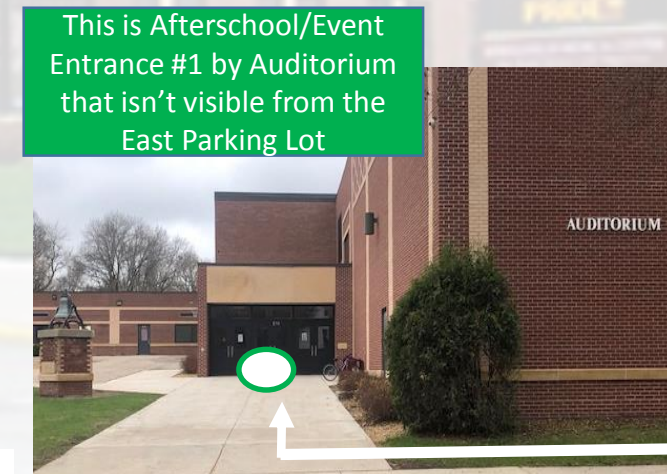

View from Burns Ave. south of Winona

SCHOOL SECURITY AND SAFETY NEEDS

This is our second entrance on the West side of the building used for after school events.

This is Night Entrance #2 by the cafeteria.
This is a picture from the West parking lot.

The West parking lot is a smaller lot that can hold about 28 vehicles.

This entrance lacks function and requires another door to monitor for community events.

Having the West Parking and this entrance for staff use may function the best.





NEED FOR A TORNADO STORM SHELTER

**SCHOOL SECURITY
AND SAFETY NEEDS**

SCHOOL AND COMMUNITY TORNADO STORM SHELTER

This project will address added safety by including a tornado storm shelter by elongating the main hallway area to provide space required. This tornado storm shelter will be available to the community outside the school day. The school is an ideal location for a tornado shelter as it is accessible for lives that are at Brown's Park, Sticker Field, downtown businesses, and for neighbors who may need shelter. It is estimated that 1,600 residents live within a half-mile drive and almost 900 residents within a 4 block walk of the school. FEMA identifies these as potential residents that would reasonably have access to this tornado shelter, if needed.

STATE OF MN BUILDING CODE CHANGE IN MARCH OF 2020 REQUIRING TORNADO SHELTERS IN SCHOOLS

Building codes and requirements evolve as standards change. In March of 2020, the State of Minnesota began implementation of the ICC 500 building code requirement for storm shelters. This code now requires any new school construction to include a tornado storm shelter. For Brown County, tornado shelters must withstand a 250 mph tornado and will include added project costs. ISG, Inc. has determined no current building sections meet this code requirement and renovating a current area is cost prohibitive. Many codes are enforced when property improvements or sale of property occurs. Updating septic systems for rural or lake property is an example of this.

\$1.460 FEMA GRANT (PENDING) WILL REDUCE PROJECT COST

On November 25, 2020, the school district applied for a FEMA grant for \$1.460 M to subsidize the additional cost for this tornado shelter. These funds will be applied to the bond principal in Question 1. Reducing the project tax impact accordingly.

Facility Task Force Recommendation to address School Campus Safety and Security Issues.

*Consensus of this committee is to address the campus security and safety needs by the following:

- a) Create a Main Entrance by the auditorium with today's safety standards. Relocate the high school principal office in the most prominent area as seen in today's building designs to help improve school security, accessibility to the public, and can intuitively serve as the school's main entrance for day and night use.
- b) Remodel the Elementary and District Office Entrances to today's school safety standards of being a controlled entrance.
- c) Address parent pick-up and drop off zones and the high school office addition by the auditorium by acquiring property on Burns Ave. between Winona St. and Wilson St. This will improve the space issue of the school and allow a design of an improved parent pick up and drop off zones.
- d) Plan for a "safe" area for high school students to go after-school who don't go home as many wait for late practices, school programs, or for parent pick-up.
- e) Embed a Community Tornado Shelter compliant with MN State Building Code and FEMA regulations and seek Federal FEMA funds to offset project costs and local tax impact.

School Site Plan Addresses School Safety and Security Needs.

SPRINGFIELD SCHOOL PRIORITIZED SITE PLAN

SCHOOL SECURITY AND SAFETY NEEDS

LEGEND

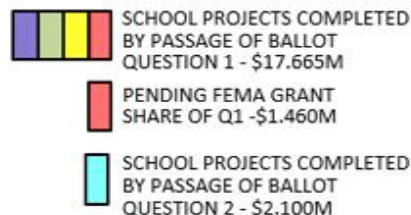

NOTE: QUESTION 2 PENDING QUESTION 1 PASSING
BOTH QUESTIONS TOTAL-\$19.765M
BOTH QUESTIONS WITH FULL FEMA GRANT -\$18.305M

Q2. Projects would address Cafeteria and Choir capacity as well as the need for a locker room renovation. The cafeteria would expand into the current Choir Room by renovating the old locker rooms into an updated Choir Room. This would require new locker rooms be added on the new east addition. The cost to build new locker rooms was minimally different between renovating the old locker rooms and integral in simultaneously meeting the Cafeteria & Choir needs in the most cost efficient way.

Here's how these school safety and security needs can be addressed.

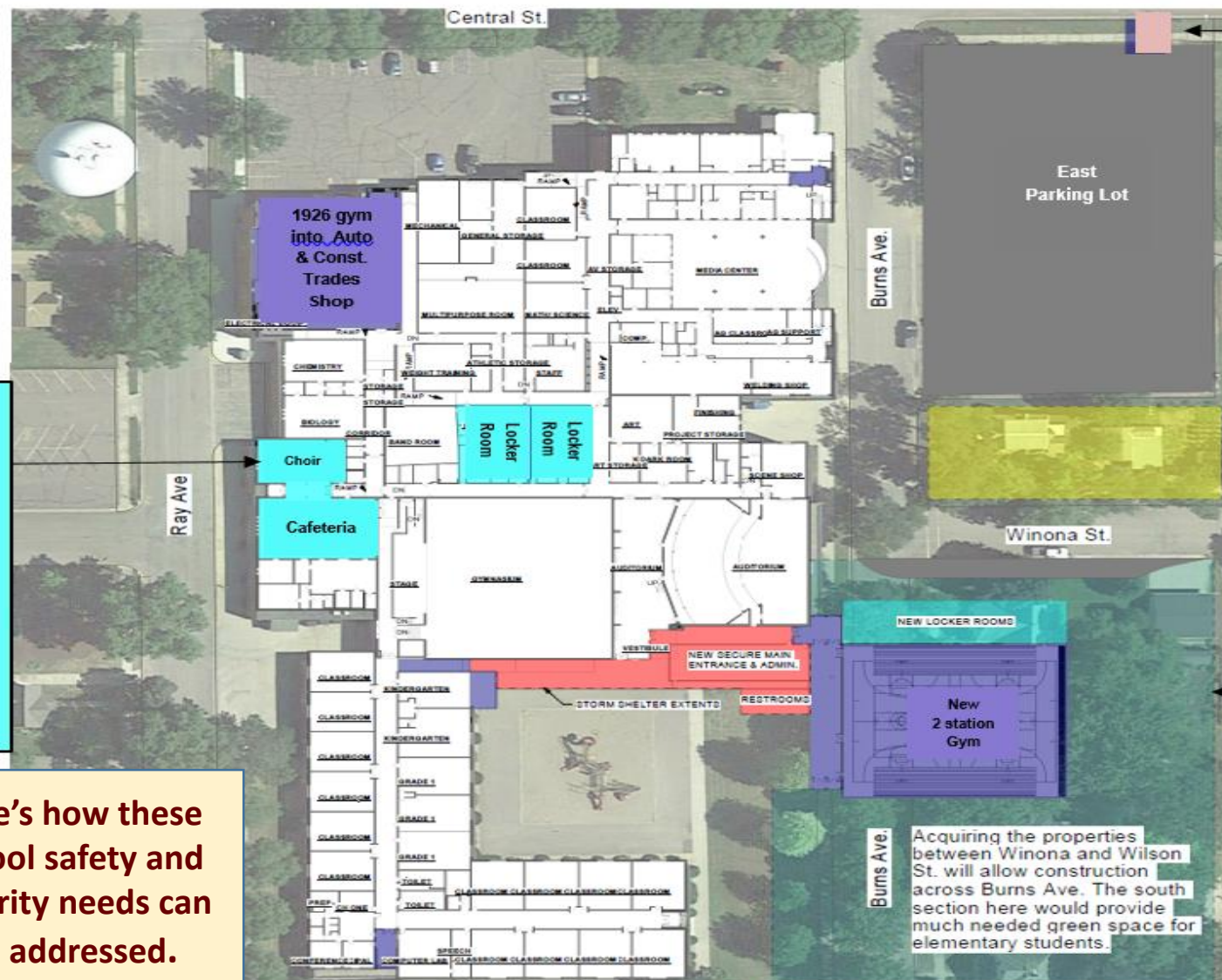

New traffic outlet onto Central Ave. This is not a part of the bond project and will be done with Central Ave. renovation.

Q1. Proposed is to acquire property to extend the east parking lot to Winona St. Handicap & visitor parking would flip to the very south, improving accessibility to a new main entrance in an intuitive & logical location.

Q1. School projects proposed would utilize acquired land here to provide the common secure main entrance and gymnasium addition due to 1926 gym renovation into a CTE Auto and Construction Trades Shop. Update and secure other administrative entrances and provide a safer parent drop-off and pick-up zone along Wilson St.

Q1. HVAC system replacement. A new heating and cooling system across the entire building. Air exchange standards will be met and an energy efficiency system with updated controls utilized. Eliminates steam system and expensive repairs. Addresses classroom noise issue.

Q1. Community Tornado Storm Shelter. Required by the State of MN building code, a tornado shelter to serve the school and community is embedded into the project in the most cost effective way. \$1.460M FEMA grant request has been submitted to offset project costs.

Acquiring the properties between Winona and Wilson St. will allow construction across Burns Ave. The south section here would provide much needed green space for elementary students.

NEW SITE PLAN

ARCHITECTURE + ENGINEERING + ENVIRONMENTAL + PLANNING

www.is-grp.com

Wilson St.
SPRINGFIELD PUBLIC SCHOOLS
SPRINGFIELD, MINNESOTA - 18829 - 10/14/20



ISG

Springfield School District



If you have any questions, please don't hesitate to contact:

Keith Kottke

Superintendent

507-723-4283

keith.kottke@springfield.mntm.org